

# Physician Education Express



## Apheresis Ports

Audience: Port Trained Nurses

Education Level- **Yellow**

October, 2020

### Background:

- New Bard port (PowerFlow Port) - only used/accessed for Apheresis
- Previously used only Angiodynamics - causing confusion among the occasional inpatient encounter
- Currently, PowerFlow Port used with low volume chronic patient population (i.e. neuro- Myasthenia Gravis, Heme-sickle cell)

### Situation:

- Seen at least twice within the last few months on inpatient units at the Adult AHC.
- Need to make sure RN aware not to access or attempt to access Bard port used for apheresis.
  - NOTE: If Apheresis is needed to perform a procedure on a patient with one of the Bard ports, we will bring the supplies needed from our department to access and de-access the port once the procedure is done. Even if a patient would need multiple days of Apheresis, the port would be accessed and de-accessed each day.

### Highlights

#### Issues:

- Seen at least twice within the last few months on inpatient units at the Adult AHC.
- Need to make sure RN aware not to access or attempt to access Bard port used for apheresis.

### Assessment:

- Provide clinical practice update to inpatient RNs trained in accessing ports to not attempt to access new Bard Apheresis Port.

### Recommendations:

- Note the difference in shape from Power Ports upon palpation as demonstrated in pictures below, denoting difference in accessing this port.
- Must get x-ray prior to accessing port to verify type of port to access.
- Contact Apheresis if you suspect patient has PowerFlow Port.

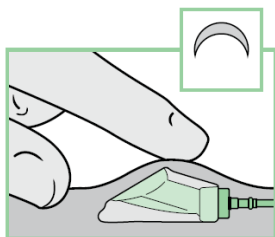

Place your finger on the high point of the port to identify the top of the funnel.

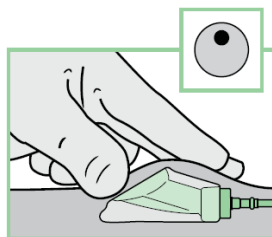

Palpate the funnel, which should feel concave and hollow.

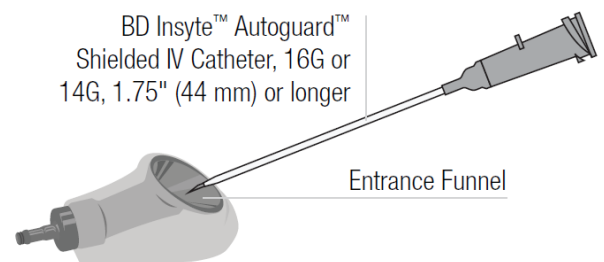

BD Insyte™ Autoguard™  
Shielded IV Catheter, 16G or  
14G, 1.75" (44 mm) or longer

Entrance Funnel